

INSTALLATION INSTRUCTIONS

MATRIX INBUILT ZERO CLEARANCE KIT

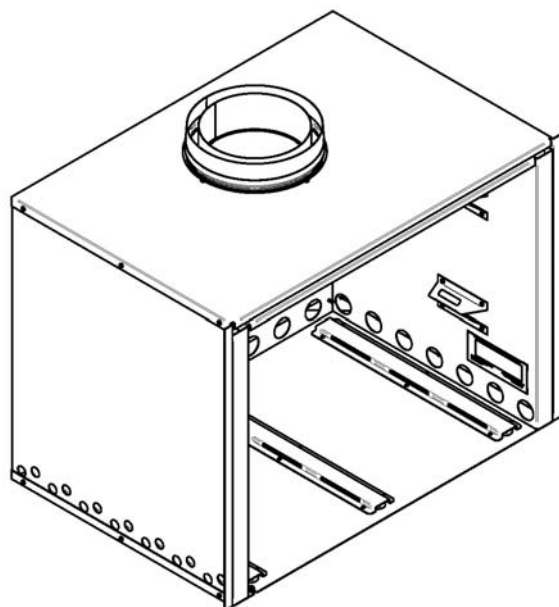

BEYOND
fire



YOUR OSBURN MATRIX INBUILT HAS BEEN TESTED WITH OUR ORIGINAL OSBURN MATRIX ZERO CLEARANCE KIT. THE INSTALLATION OF ANY OTHER ZERO CLEARANCE KIT WILL VOID YOUR WARRANTY.

Distributed by
Glen Dimplex Australasia

NEW ZEALAND

38 Harris Road, East Tamaki, Auckland
Ph: 09 274 8265 Fax 09 274 8472
Email: sales@glendimplex.co.nz
www.glendimplex.com.au

AUSTRALIA

Unit 1, 21 Lionel Road
Mount Waverley, Victoria 3149
Ph: 1 300 554 155 Fax 8787 3570
Email: sales@glendimplex.com.au
www.glendimplex.com.au



This manual is available for free download on the manufacturer's web site. It is a copyrighted document. Re-sale is strictly prohibited. The manufacturer may update this manual from time to time and cannot be responsible for problems, injuries, or damages arising out of the use of information contained in any manual obtained from unauthorized sources.

READ AND KEEP THIS MANUAL FOR REFERENCE

Table of content

ZERO CLEARANCE KIT CONTENTS 3

1 ZERO CLEARANCE KIT SPECIFICATIONS 5

2 Safety Information 6

2.1 Summary of Installation Cautions and Warnings 6

3 Regulations Covering Wood inbuilt Installation 7

4 Assembly 8

5 Installation16

5.1 Positioning the Unit 16

5.1.1 Framing 16

5.1.2 Floor Protector 18

5.1.3 The Flue System 18

5.1.4 Finish 18

6 The Flue System21

6.1 Suitable Flue Systems 21

6.2 Triple Skin Flue Kit Installation 21

6.3 Minimum Flue System Height 21

Appendix 1: Faceplate Installation22

THANK YOU FOR CHOOSING THIS WOOD INBUILT WITH ZERO CLEARANCES KIT

We want to congratulate you on your purchase and wish to help you get maximum satisfaction from your wood inbuilt. In the pages that follow, we will give you technical specifications regarding installation of the Matrix inbuilt in this zero clearances kit.

The following instructions complies with AS/NZS 4012/4013 (1999) and AS/NZS 2918:2001 standards.

Please read this entire manual before you install and use your new wood inbuilt. Failure to follow instructions may result in property damage, bodily injury, or even death. It is important that you follow the installations guidelines exactly.

Consult your local city, borough or shire council about restrictions and installations requirements in your area and the need to obtain a permit.

This heating unit is designed to serve as a supplementary heat source. We recommend that a primary heat source also be available in the home. The manufacturer cannot be responsible for costs associated with the use of another heating system.

KEEP THIS INSTRUCTION MANUAL FOR FUTURE REFERENCE.

ZERO CLEARANCE KIT CONTENTS

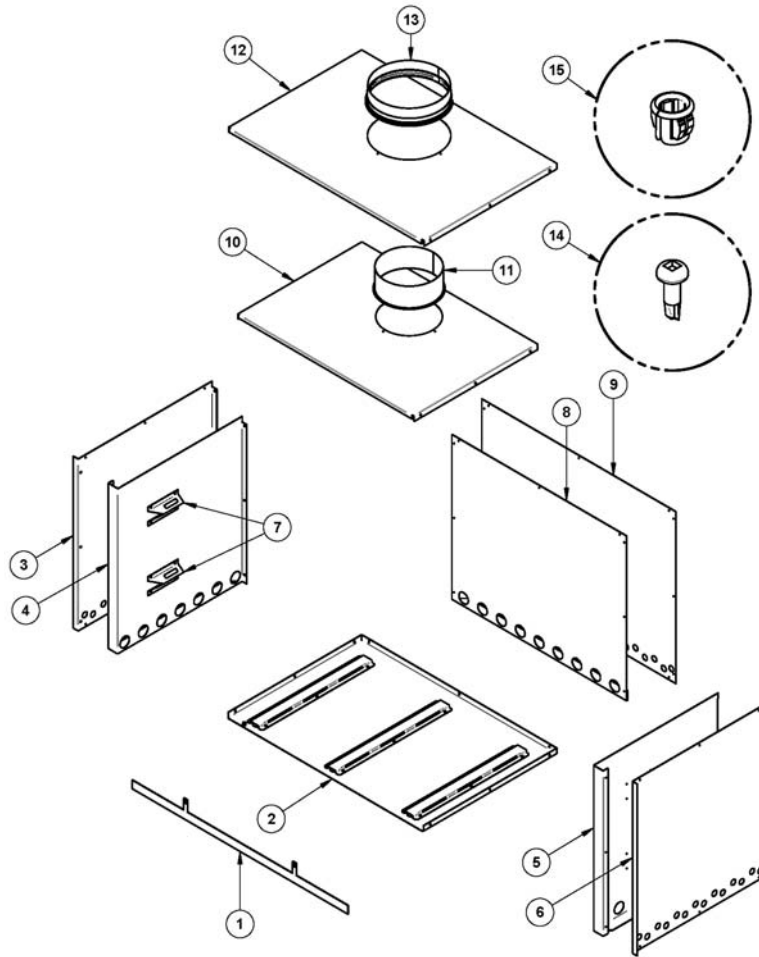

#	Item	Description	Qty
1	PL36191	LOWER METAL STRIP	1
2	SE36180	ZERO CLEARANCE ASSEMBLED BASE	1
3	PI36188	OUTER JACKET LEFT SIDE PANEL	1
4	PL36184	INNER JACKET LEFT SIDE PANEL	1
5	PL36185	INNER JACKET RIGHT SIDE PANEL	1
6	PL36189	OUTER JACKET RIGHT SIDE PANEL	1
7	PL36192	FIREBOX GUIDE	4
8	PL36183	INNER JACKET BACK PANEL	1
9	PL36187	OUTER JACKET BACK PANEL	1
10	PL36186	INNER JACKET TOP PANEL	1
11	PL36178	INNER JACKET COLLAR	1
12	PL36190	OUTER JACKET TOP PANEL	1
13	PL36179	OUTER JACKET COLLAR	1
14	30153	METAL SCREW #8 X 1/2" PAN SQUARE TEK BLACK SELF DRILLING	70
15	30090	GROMMET	1

Other required parts (not included):



Triple Skin Flue System

Required tools for installation:

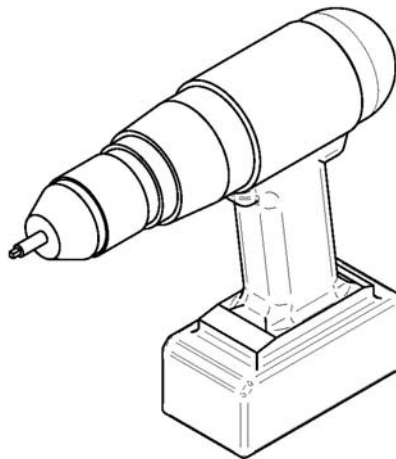

Powered driver

1 ZERO CLEARANCE KIT SPECIFICATIONS

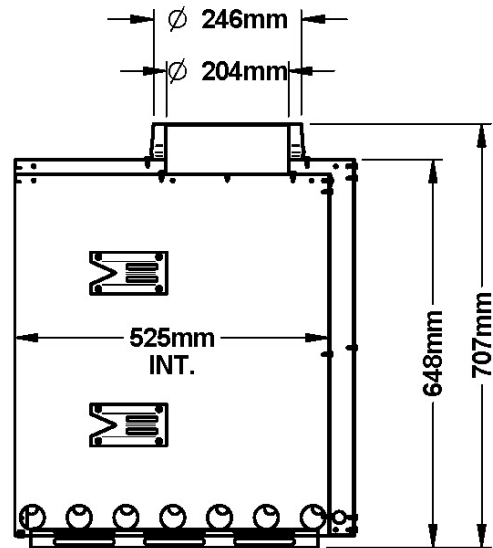
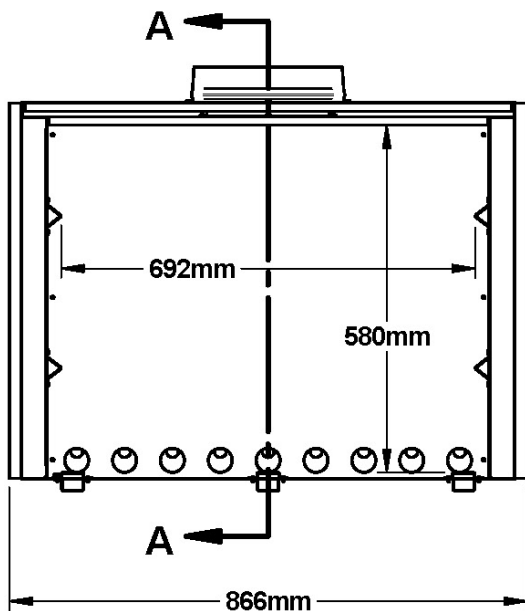
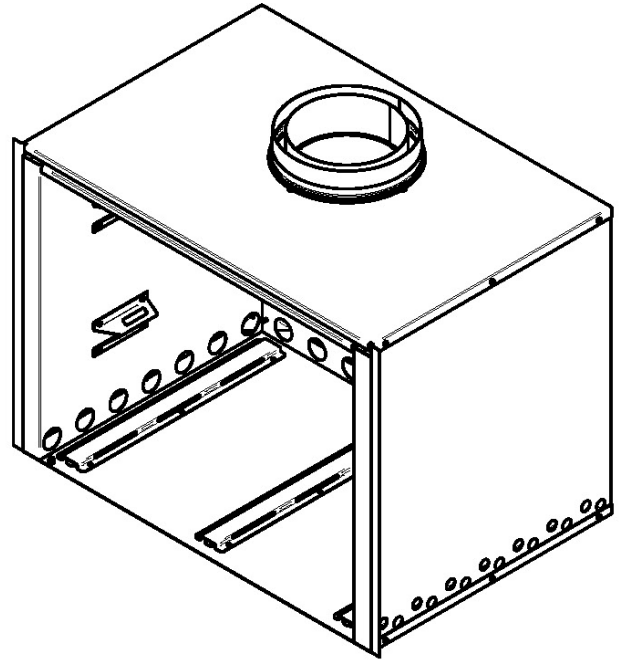
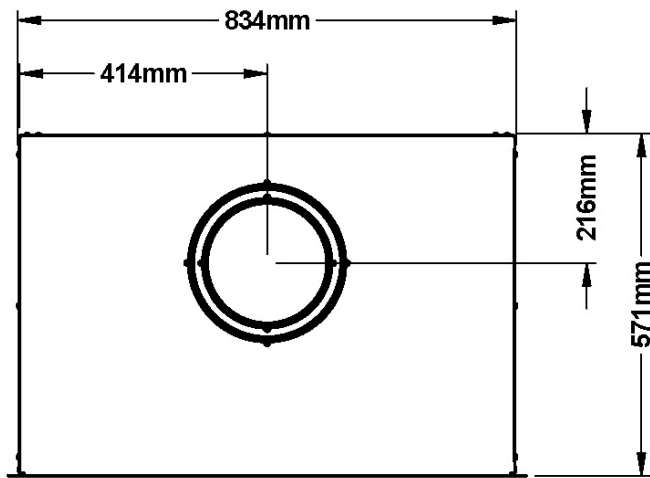

SECTION A-A

2 SAFETY INFORMATION

2.1 SUMMARY OF INSTALLATION CAUTIONS AND WARNINGS

- DISCONNECT THE FAN'S ELECTRIC POWER BEFORE SERVICING.
- THE INFORMATION GIVEN ON THE CERTIFICATION LABEL AFFIXED TO THE APPLIANCE ALWAYS OVERRIDES THE INFORMATION PUBLISHED, IN ANY OTHER MEDIA (OWNER'S MANUAL, CATALOGUES, FLYERS, MAGAZINES AND/OR WEB SITES).
- MIXING OF APPLIANCE OR FLUE-SYSTEM COMPONENTS FROM DIFFERENT SOURCES OR MODIFYING THE DIMENSIONAL SPECIFICATION OF COMPONENTS MAY RESULT IN HAZARDOUS CONDITIONS. WHERE SUCH ACTION IS CONSIDERED, THE MANUFACTURER SHOULD BE CONSULTED IN FIRST INSTANCE.
- CRACKED AND BROKEN COMPONENTS, E.G. GLASS PANELS OR CERAMIC TILES, MAY RENDER THE INSTALLATION UNSAFE.
- CONNECT THIS WOOD INBUILT IN CONJUNCTION WITH THE ZERO CLEARANCES KIT ONLY TO A TRIPLE SKIN FLUE KIT FOR USE WITH SOLID FUEL CONFORMING TO NATIONAL AND LOCAL BUILDING CODES.
- USE SMOKE DETECTORS IN THE ROOM WHERE YOUR WOOD INBUILT IS INSTALLED.
- IF REQUIRED, A SUPPLY OF COMBUSTION AIR SHALL BE PROVIDED TO THE ROOM OR SPACE.
- KEEP FURNITURE AND DRAPES WELL AWAY FROM THE WOOD INBUILT.
- DO NOT CONNECT TO OR USE IN CONJUNCTION WITH ANY AIR DISTRIBUTION DUCTWORK UNLESS SPECIFICALLY APPROVED FOR SUCH INSTALLATION.
- DO NOT CONNECT THIS UNIT TO A FLUE OR FLUE SYSTEM SERVING ANOTHER APPLIANCE.

3 REGULATIONS COVERING WOOD INBUILT INSTALLATION

IT IS RECOMMENDED THAT THE INSTALLATION OF YOUR OSBURN WOOD INBUILT AND ITS ZERO CLEARANCES KIT BE CARRIED OUT BY A QUALIFIED SPECIALIST INSTALLER. IF ANY ELECTRICAL WORK IS REQUIRED, IT MUST BE CARRIED OUT BY A LICENSED ELECTRICIAN.

WARNING: The instructions pertaining to the installation of your wood inbuilt with the zero clearances kit comply with the AS/NZS 2918:2001 standard. **THE APPLIANCE AND FLUE SYSTEM MUST THEREFORE BE INSTALLED IN ACCORDANCE WITH AS/NZS 2918:2001 AND THE APPROPRIATE REQUIREMENTS OF THE RELEVANT BUILDING CODE OR CODES.**

WARNING: APPLIANCES INSTALLED IN ACCORDANCE WITH THIS STANDARD SHALL COMPLY WITH THE REQUIREMENTS OF AS/NZS 4012/4013 (1999) WHERE REQUIRED BY THE REGULATORY AUTHORITY, I.E. THE APPLIANCE SHALL BE IDENTIFIABLE BY A COMPLIANCE PLATE WITH THE MARKING “TESTED TO AS/NZS 4012/4013 (1999)”.

ANY MODIFICATION OF THE APPLIANCE OR OF THE ZERO CLEARANCES KIT THAT HAS NOT BEEN APPROVED IN WRITING BY THE TESTING AUTHORITY IS CONSIDERED TO BE IN BREACH OF THE APPROVAL GRANTED FOR COMPLIANCE WITH AS/NZS 4012/4013 (1999).

4 ASSEMBLY

Assemble the outer panels (A), (B), (C) and (D) with the screws provided with the zero clearance kit.

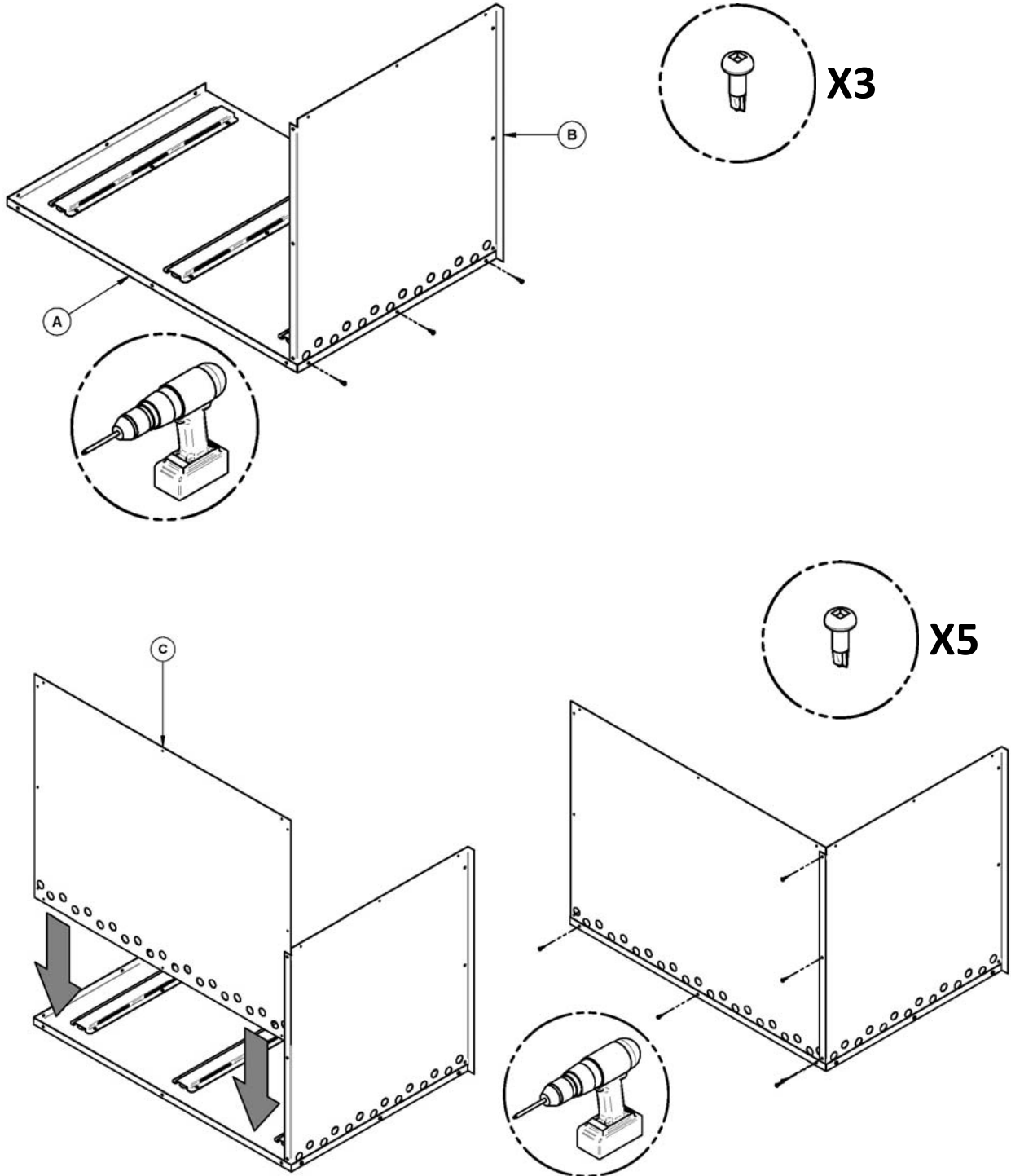

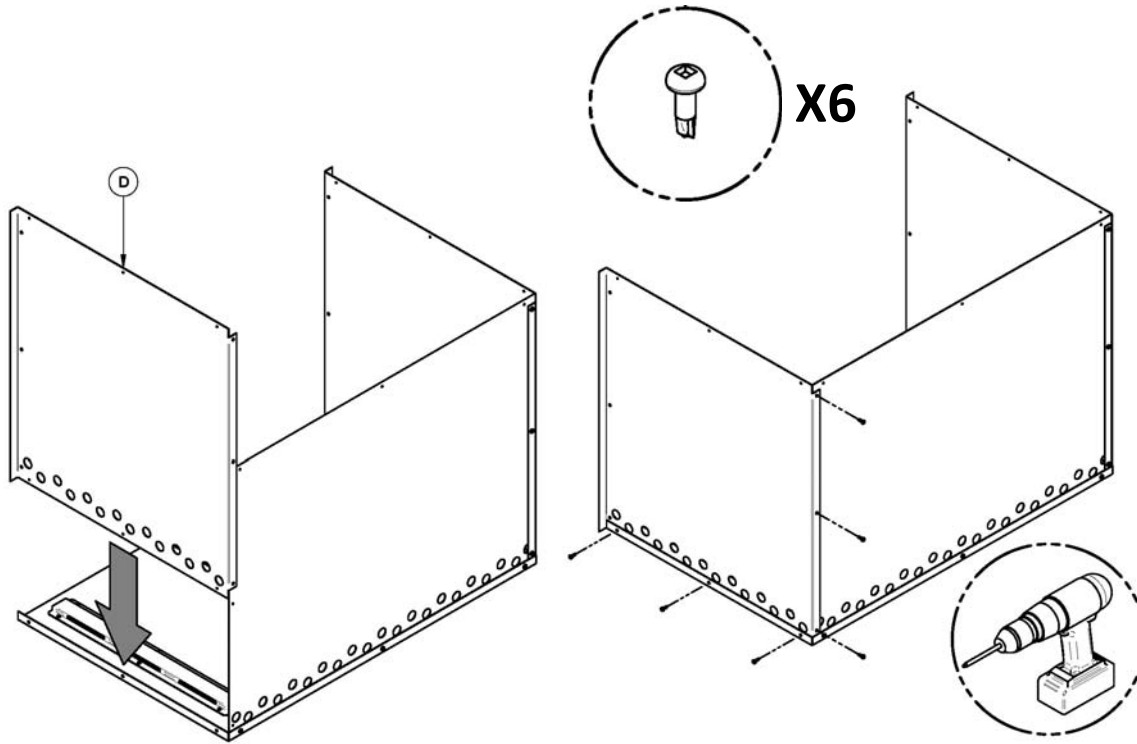

Assemble inner jacket panels (E), (F) and (G).

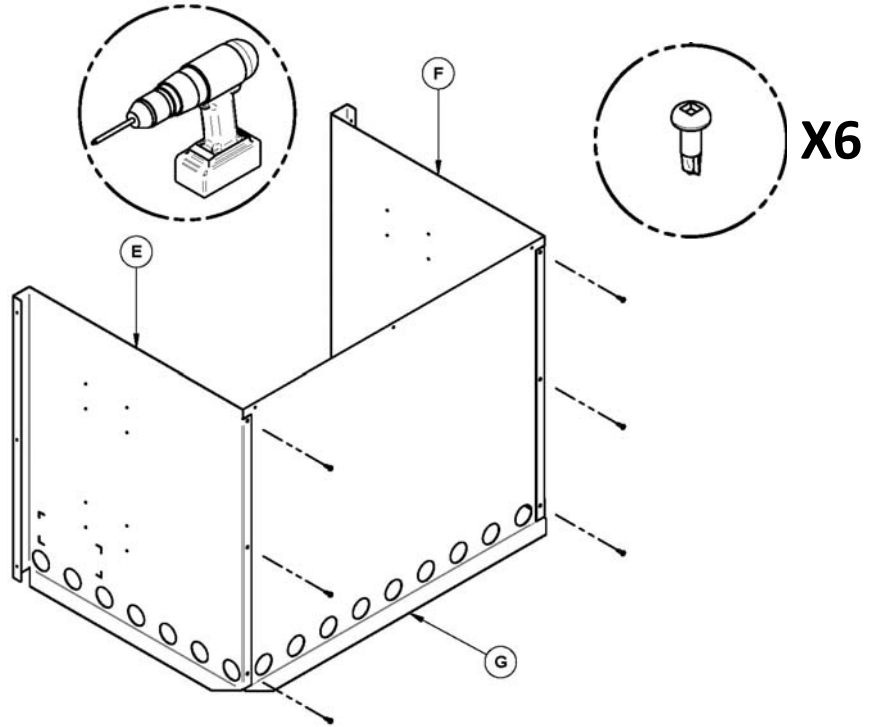

Install the four inner firebox guides (H), two on each assembled sides.

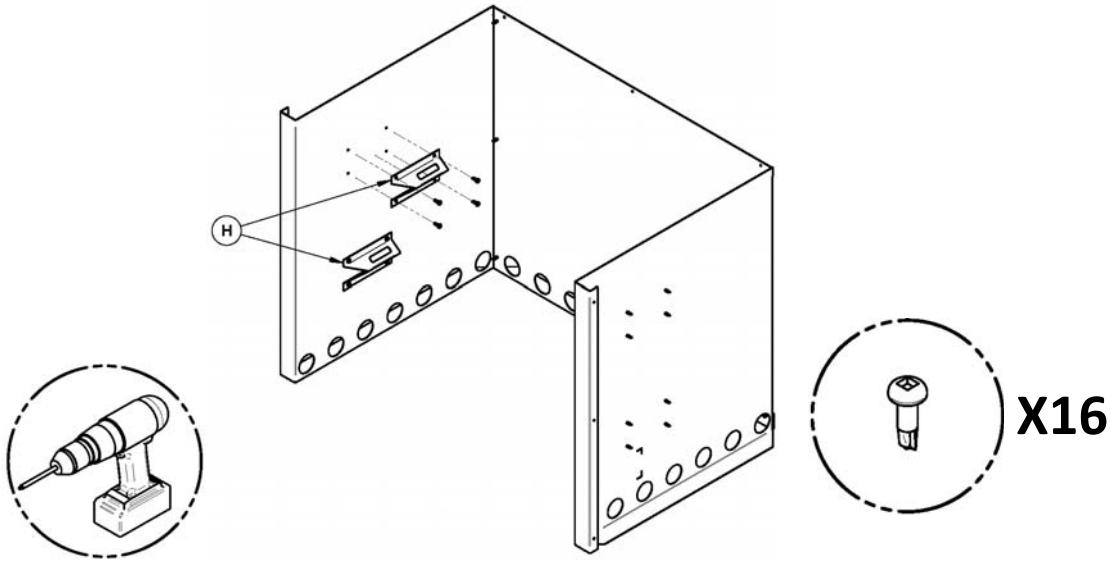

Secure the inner jacket top panel (I) to the assembled sides.

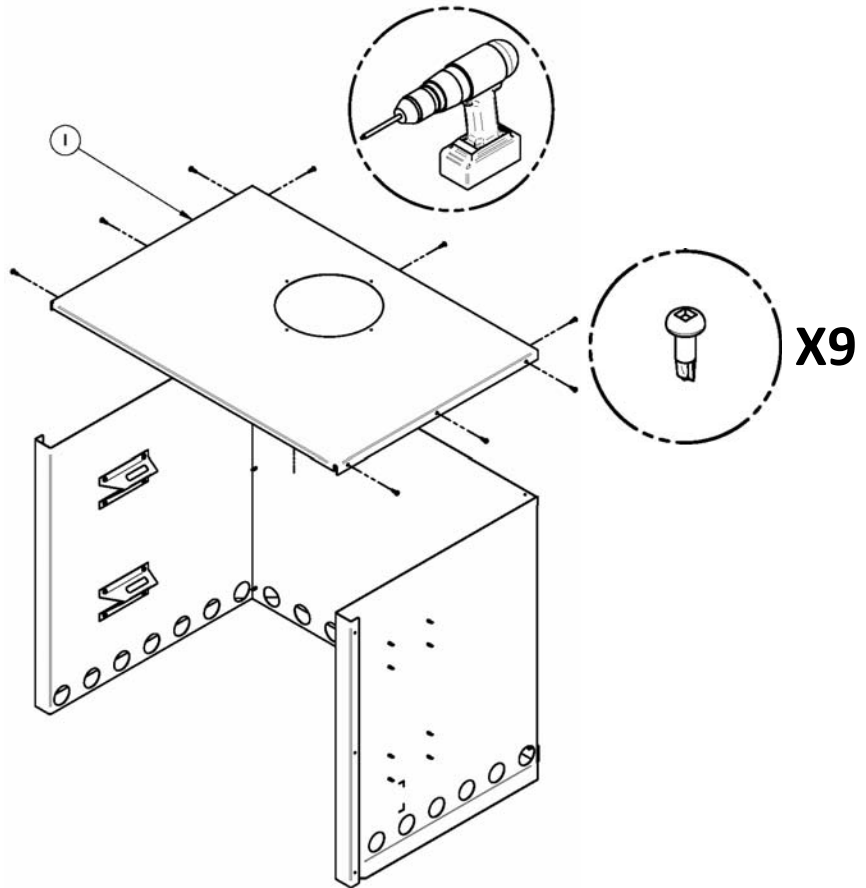

Assemble the inner jacket collar (J) to the inner jacket.

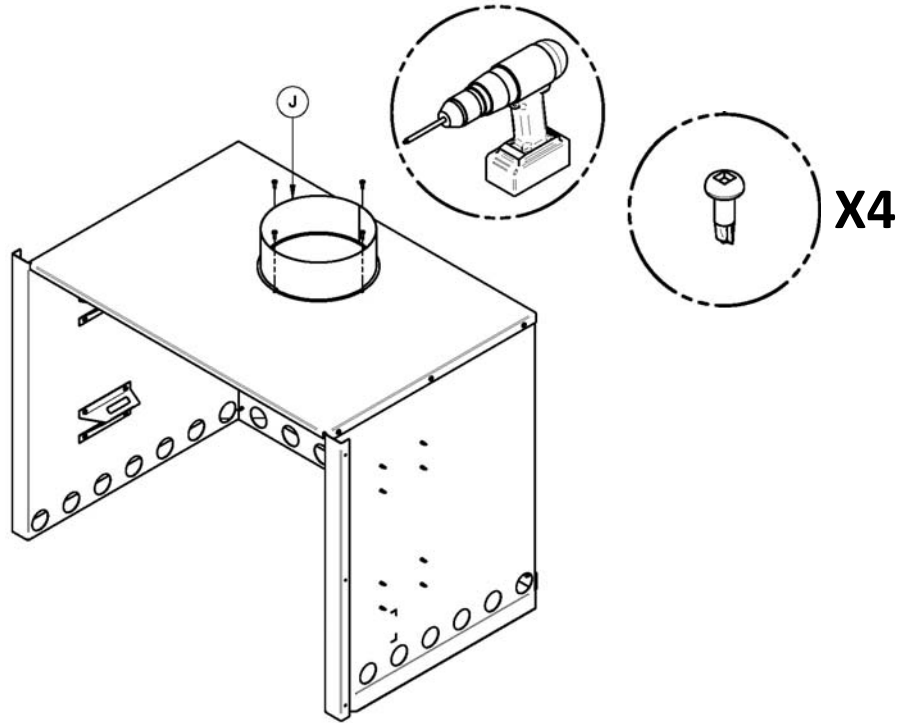

Slide the inner casing inside the outer jacket.

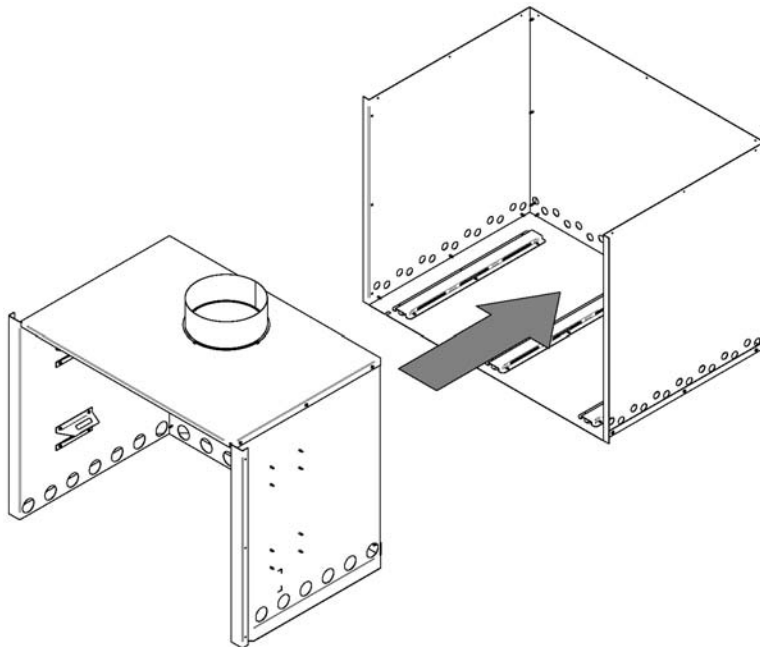

Secure the inner casing to outer jacket.

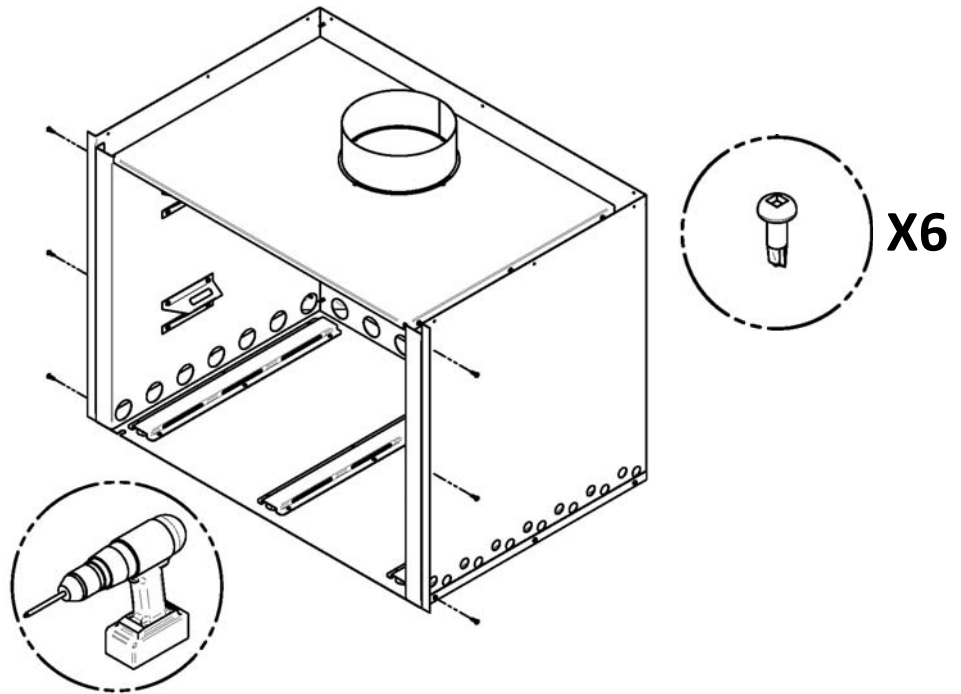

Assemble the outer jacket collar (L) to the outer jacket top panel (K).

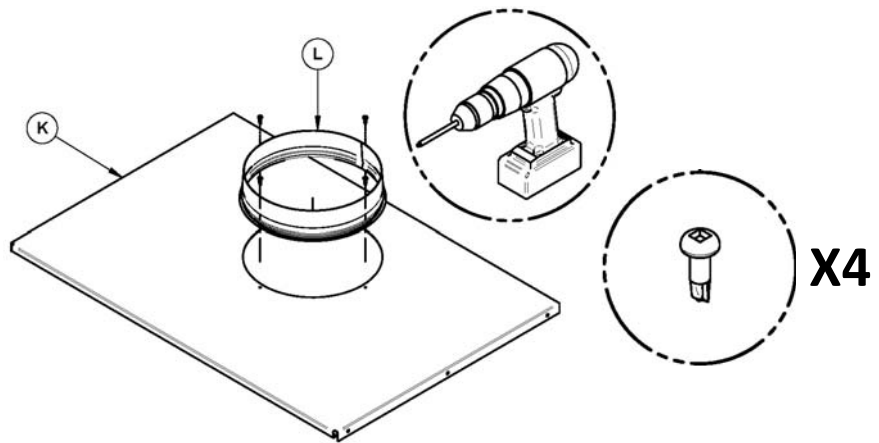

Assemble the outer jacket top panel of the outer jacket.

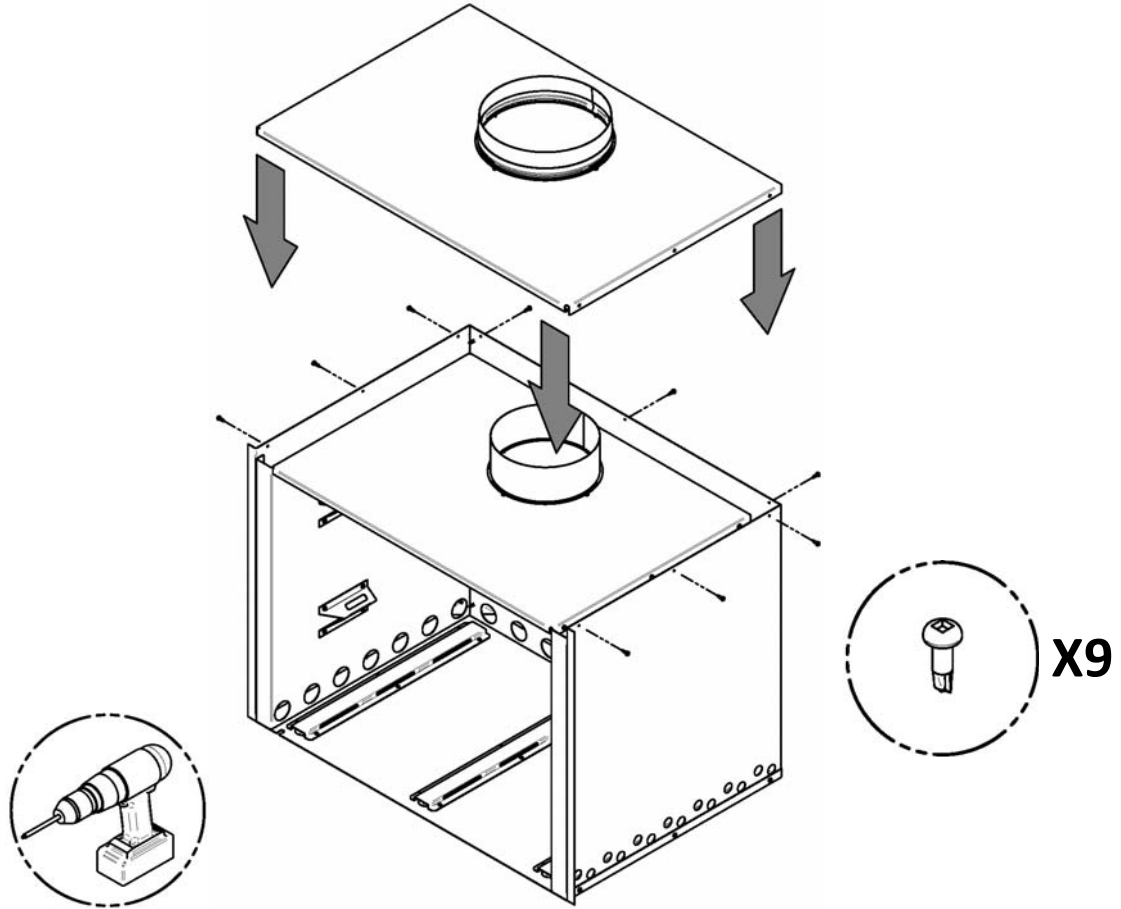

The Matrix wood inbuilt is equipped with a reversible door in case you prefer a door opening on the other side. Refer to the Matrix Inbuilt's manual if you wish to avail yourself of this feature.

Also, since the information given on the certification label affixed to the appliance or to the zero clearance kit always overrides the information published in any other media (owner's manual, catalogues, flyers, magazines and/or web sites), it is important to refer to it in order to have a safe and compliant installation. In addition, you will find information about your wood inbuilt (model, serial number, etc.). You can find the inbuilt's certification label on the right side, towards the front of the outside of the air jacket.

The wood inbuilt's zero clearance kit's certification label (M), is included in the kit. You must affix it to the marked position; inside, towards the front of the right hand side panel (see **Detail A**).

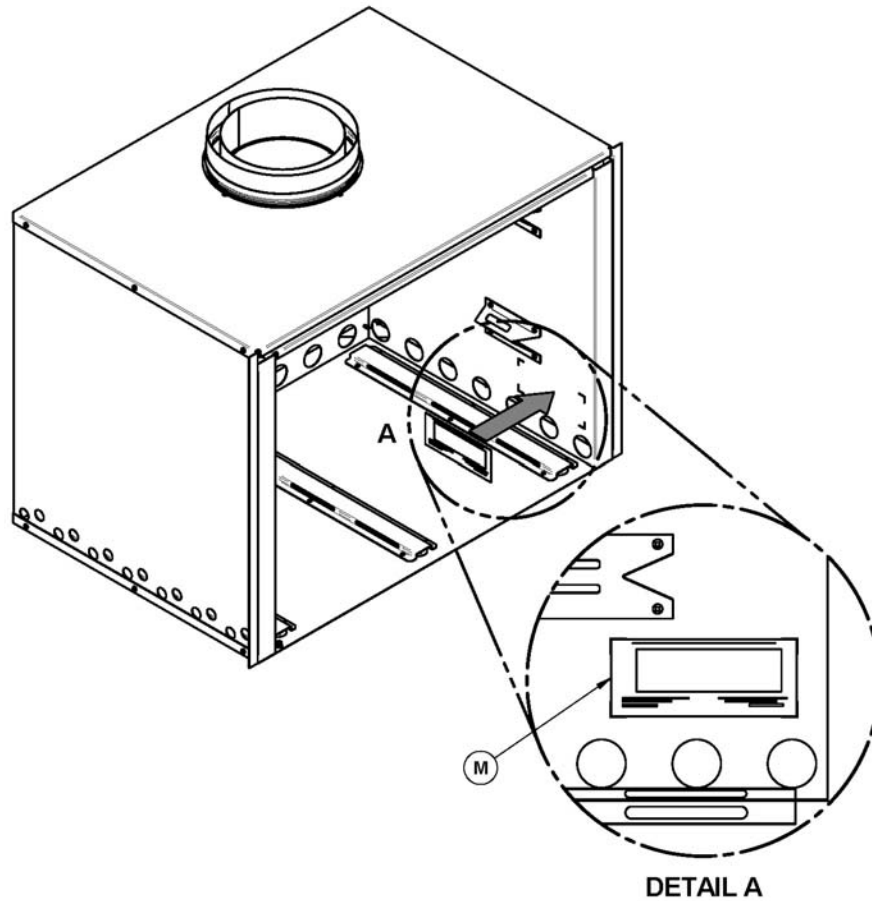

To access the certification labels, the faceplate and/or wood inbuilt may need to be removed. Therefore, we recommend that you note both, (the wood inbuilt's zero clearance kit and Matrix wood inbuilt's) serial number on this manual, since it will be needed to precisely identify the version of the appliance in the event you require replacement parts or technical assistance.

Once the installation is performed (see **Section 5**) and the zero clearance kit is enclosed in the frame, insert the wood inbuilt inside the zero clearance kit.

Center the Matrix inbuilt (rear-front) inside the zero clearance kit in order for the appliance's flue to be aligned with the zero clearance kit's flue.

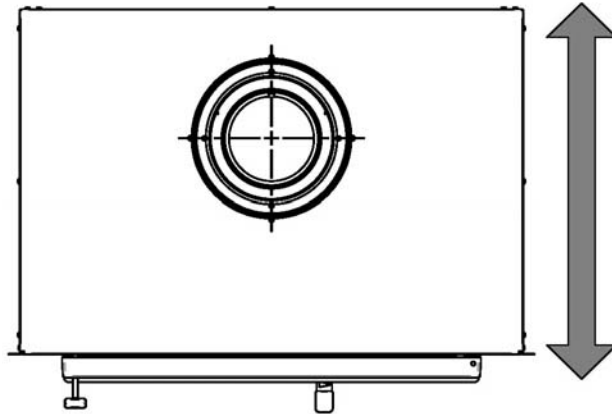

Insert the grommet (N) on the fan's power cord (O). Slide the grommet onto the opening on the base of the zero clearance kit (see **detail B**). From outside the ZC kit push the grommet in the hole until it "clips" (see **detail B**).

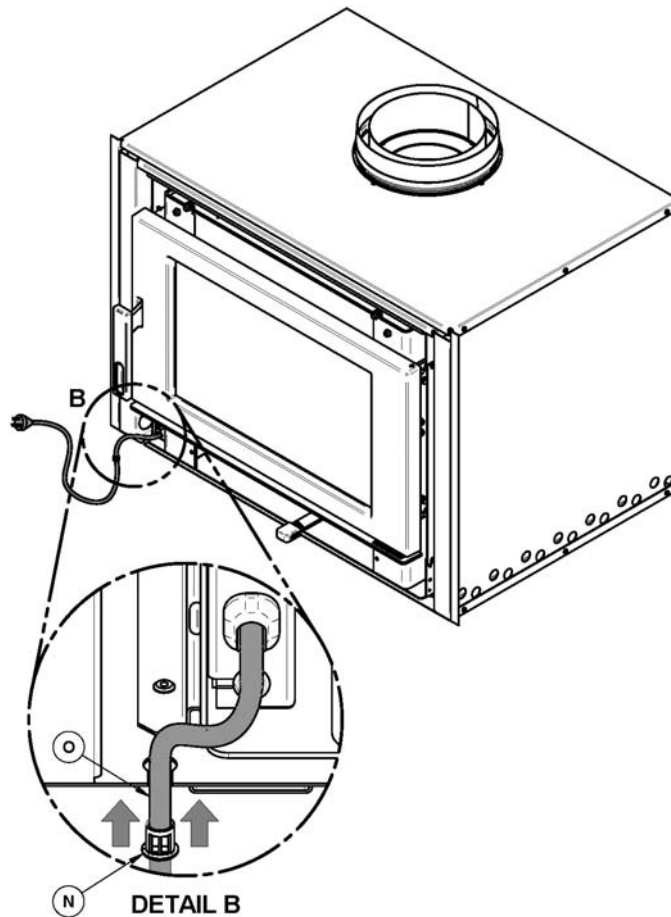

5 INSTALLATION

The clearances shown in this section have been determined by test according to procedures set out in safety standards AS/NZS 2918:2001. When the wood inbuilt inside its Matrix zero clearances kit is installed so that its surfaces are at or beyond the minimum clearances specified, combustible surfaces will not overheat under normal and even abnormal testing protocol conditions.

No part of the wood inbuilt may be located closer to heat-sensitive materials than the minimum clearances in figures given.

5.1 POSITIONING THE UNIT

Prior to determining where you are going to install the unit, verify that the flue casing can pass through ceiling space without requiring the removal of essential roof or ceiling support beam. Also, consult the clearances in this section to ensure that you respect the distance to heat-sensitive materials in every cases.

Once you have determined a suitable spot for the appliance, cut a square hole through the ceiling making sure that it is centered with the flue of the unit using a plumb line (see **Section 1** for dimensions).

5.1.1 FRAMING

The construction of the framing, facing, and mantel must be in accordance with the standards and the following illustrations:

- A. Frame the wood inbuilt inside the zero clearances kit using 5 cm x 8 cm (2" x 3") or heavier lumber.

WARNING: HEAT SENSITIVE FRAMING MATERIAL CANNOT BE USED IN THE SPACE DIRECTLY ABOVE THE WOOD INBUILT AND ITS ZERO CLEARANCES KIT, EXCEPT FOR THE STUDS ABOVE THE FACING THAT SUPPORT THE FACING MATERIAL AND MANTEL. THIS AREA MUST REMAIN EMPTY UP TO THE CEILING. THE FIRST INTERNAL WALL STUD SHALL BE NO CLOSER THAN 150 MM TO THE APPLIANCE AND NO CLOSER THAN 80 MM TO THE APPLIANCE FLUE OUTER CASING.

- B. Build the frame for the zero clearances kit with vertical studs at the sides running from floor to ceiling (see **Figure 5.1.1**). Position the stud's back from the front edge of the wood inbuilt inside the zero clearances kit, a space the thickness of the facing material so that the facing can be installed flush with the wood inbuilt inside the zero clearances kit facing (within limitations of **Figures 5.1.4 (a)**). Frame headers between the vertical studs only as follows:
 - Place 45 mm x 90 mm headers, only along the upper part of the front, side and back faces. Do not put wood or any combustible material within the area above the wood inbuilt inside the zero clearances kit except on the front facing.
 - Place headers only as required to support the facing and mantel.

WARNING: DO NOT PACK REQUIRED AIR SPACES WITH INSULATION OR OTHER MATERIALS.

WARNING: THE OSBURN MATRIX AND THE ZERO CLEARANCE KIT MUST NOT BE IN CONTACT WITH ANY INSULATION OR LOOSE FILLING MATERIAL. COVER THE INSULATION WITH MATERIAL SUCH AS GYPSUM BOARD AROUND THE INBUILT.

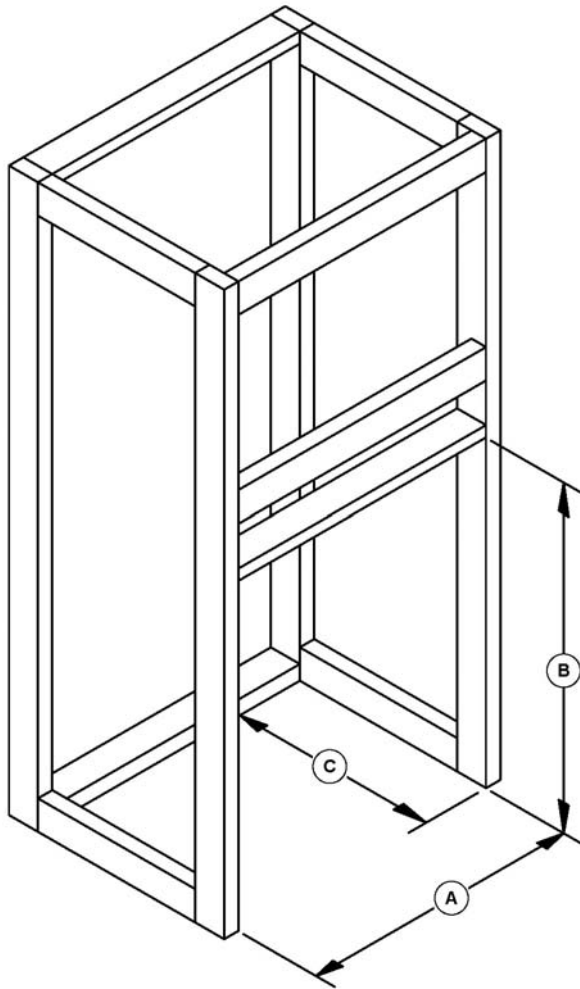

A	894 mm (min)
B	780 mm (min)
C	601 mm (min)

Figure 5.1.1

5.1.2 FLOOR PROTECTOR

If the unit is installed on a heat sensitive floor, construct an insulating floor protector that will cover the area under the ZC kit and that will project to the front of the inbuilt. The standard insulating floor is made of two layers of 12 mm cement sheet, but it can be made of any other similar material as long as it has a thermal resistivity of 0,8 m²*K/W per 4 mm thick and that the total thickness of material is 24 mm or more. The floor protection should be at least 1070 mm deep (J) x 945 mm wide (D) to the front of the inbuilt. The protection in front of the appliance (E) should always be at least 500 mm (see **Figures 5.1.4 (a) & 5.1.4 (c)**).

5.1.3 THE FLUE SYSTEM

See **Section 6**.

5.1.4 FINISH

Once the assembled ZC kit and the Osburn Matrix Inbuilt (see **Section 4**) are in the enclosure, connect the chimney to the ZC kit and fix the cladding to the enclosure taking care of respecting zones of heat sensitive and heat resistant material. (see **Figures 5.1.4 (b) & 5.1.4 (d)**)

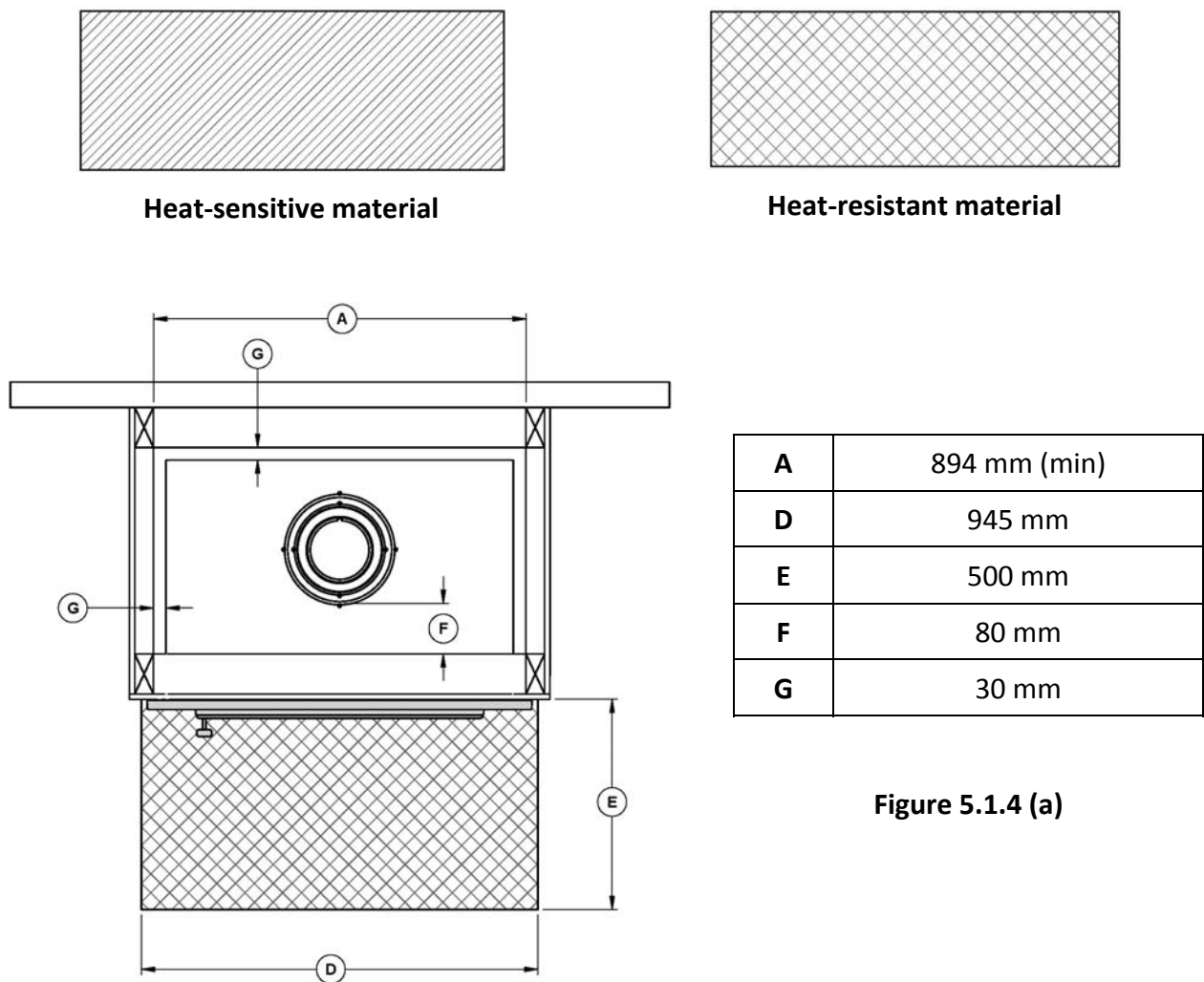
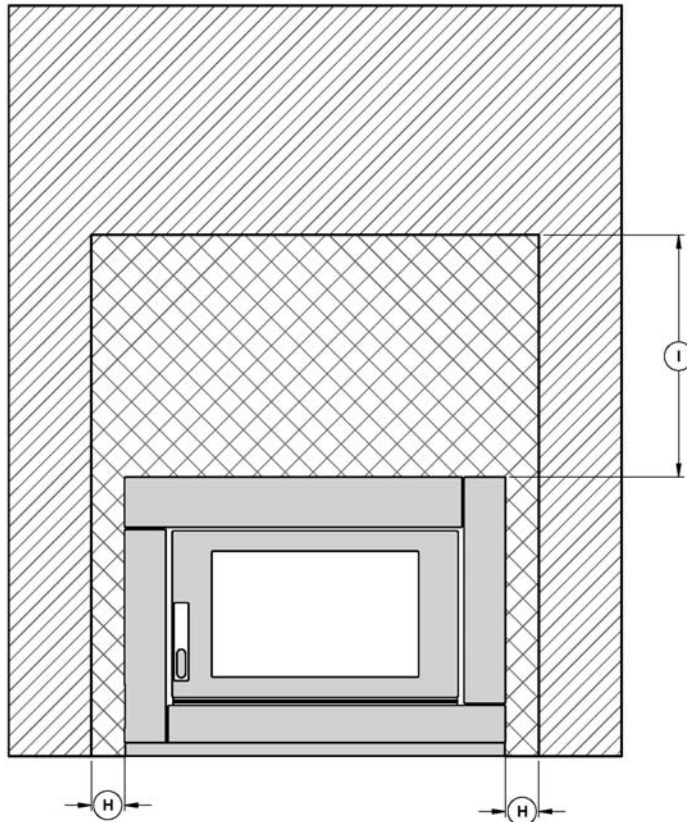
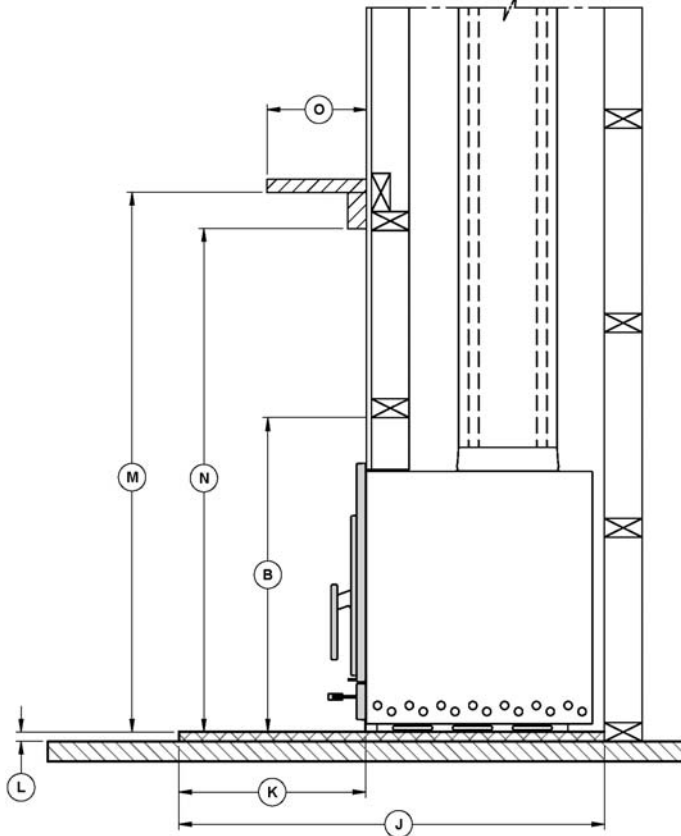

Figure 5.1.4 (a)



H	80 mm
I	580 mm

Figure 5.1.4 (b)



J	1070 mm
K	500 mm
L	24 mm
M	1340 mm (min)
N	1250 mm (min)
O	250 mm (max)

Figure 5.1.4 (c)

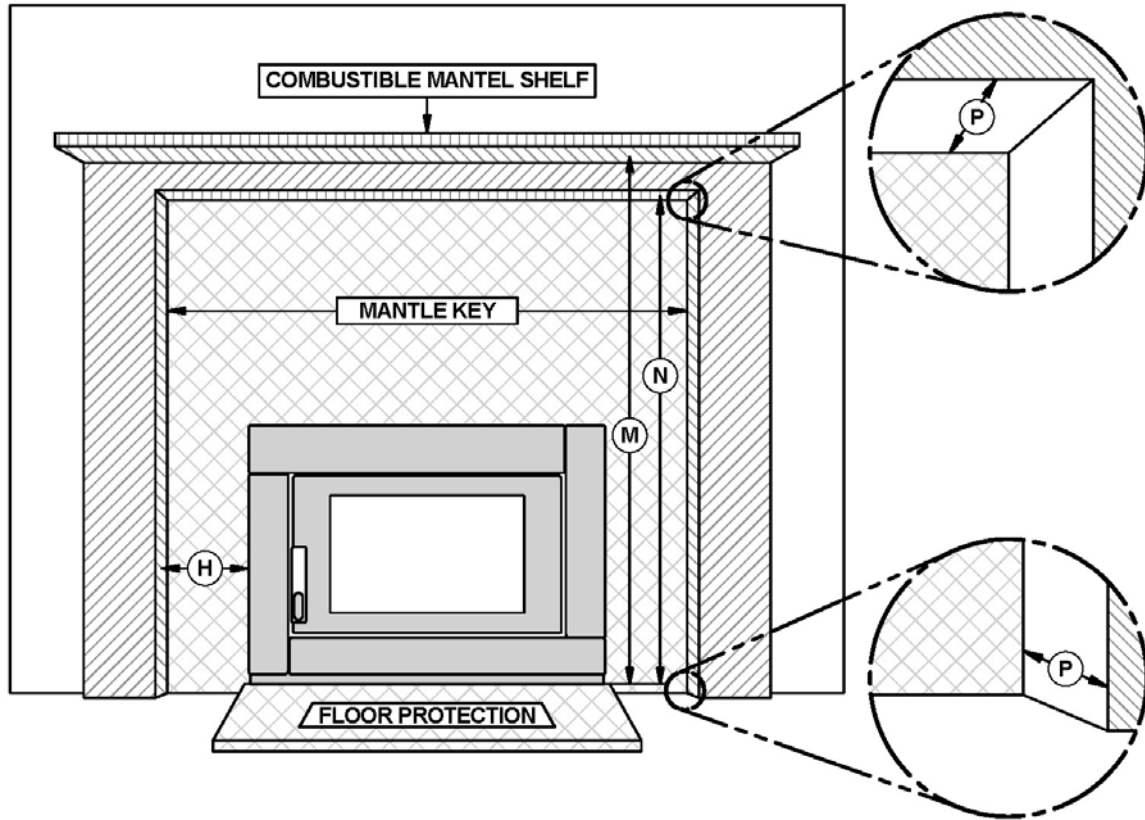

Figure 5.1.4 (d)

H	80 mm
M	1340 mm (min)
N	1250 mm (min)
P	40 mm (max)

6 THE FLUE SYSTEM

6.1 SUITABLE FLUE SYSTEMS

Your wood inbuilt will provide optimum efficiency and performance when connected to a 150 mm diameter triple flue skin.

6.2 TRIPLE SKIN FLUE KIT INSTALLATION

For appliances discharging combustion products through a chimney, the chimney shall be inspected for soundness and thoroughly cleaned before a flue pipe is installed. The air gap between the flue pipe and the chimney shall be open at the top of the chimney to the extent that the total opening area is not less than 10 000 mm². The chimney exit shall be fitted with means to prevent significant ingress of water and debris, and such means shall be constructed and fitted to maintain a total opening area at the chimney exit of not less than 10 000 mm².

The flue pipe to inbuilt used in the chimney shall comply with AS/NZS 2918.

In order to connect the wood inbuilt to the flue liner, refer to Matrix inbuilt owner's manual.

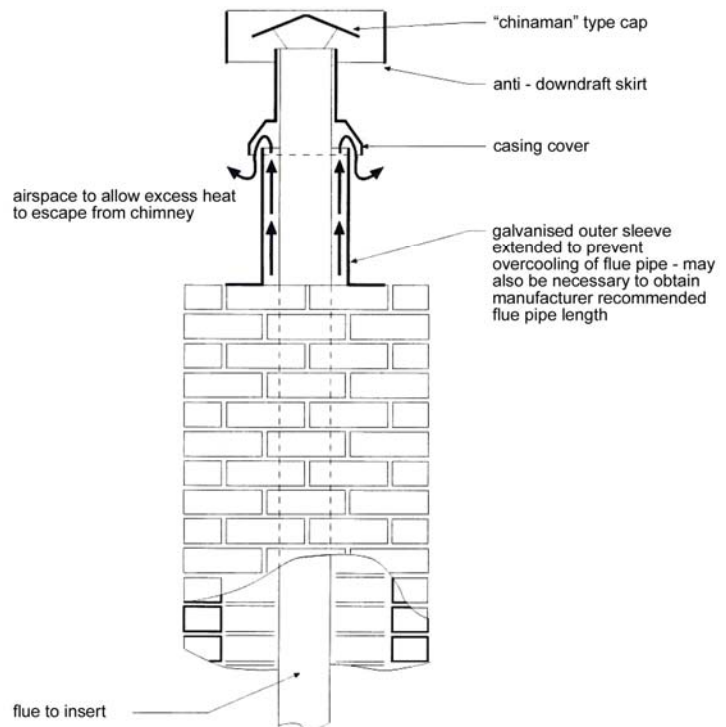

6.3 MINIMUM FLUE SYSTEM HEIGHT

See Matrix Inbuilt owner's manual.

APPENDIX 1: FACEPLATE INSTALLATION

Remove the faceplate parts of the packaging and inspect its content. Then remove the wing nut that secures the fan switch assembly to the floor of the convection air jacket for transport. The faceplate installation requires a ratchet and 3/8" box to secure each part to the front of the wood inbuilt.

The back of each faceplate part is identified as follow: (A) = 24249, (B) = 24250, (H) = 24248 and (F) = 24247.

1. Secure the fan switch assembly (D) to the faceplate (A) with 2 screws (E).
2. Align the holes in the support bracket of faceplate (A) with the screws (C) already installed on the wood inbuilt, and then tighten the screws. Use the same procedure for faceplate (B).

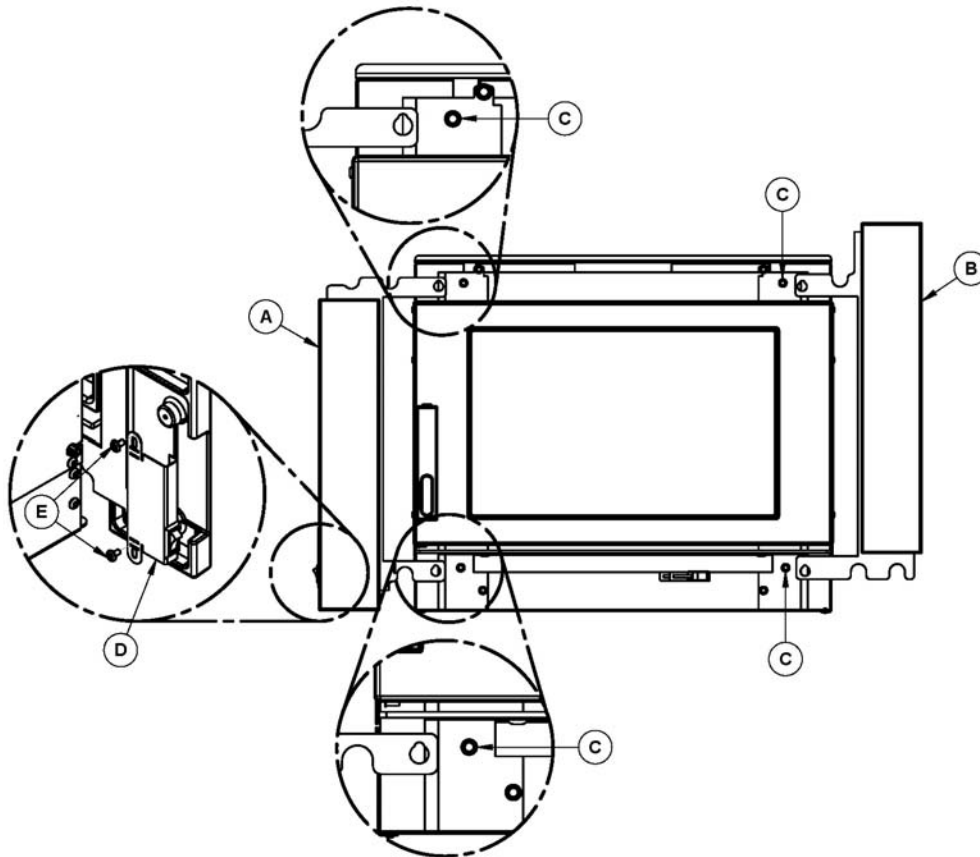

- Align the holes in the support bracket of faceplate (F) with the lower metal strip (provided with the zero clearance kit) then tighten the screws (C) already installed on the wood inbuilt.

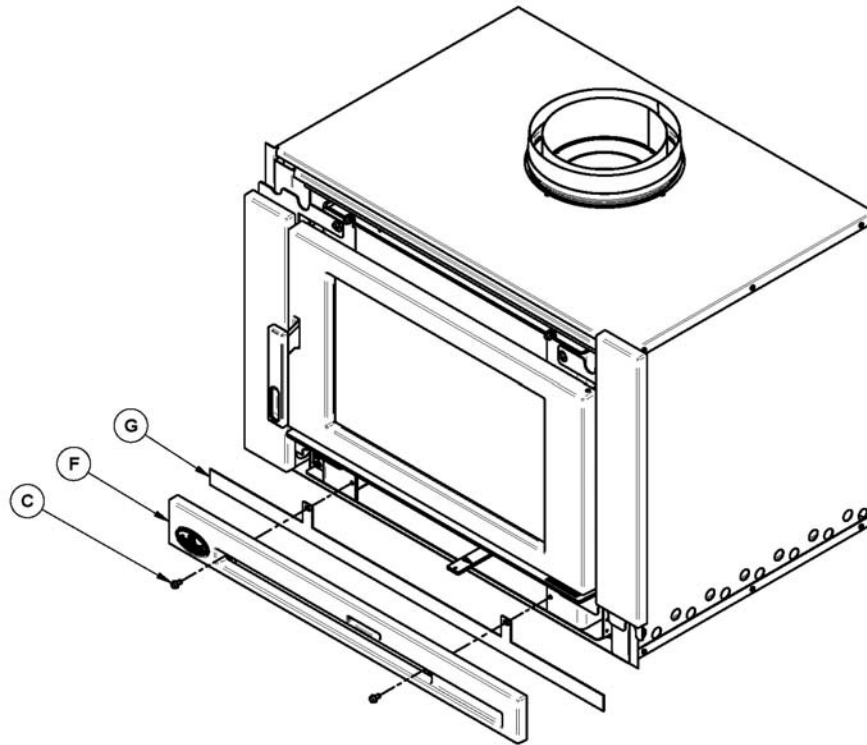

Align the holes in the support bracket of faceplate (H) then tighten the screws (C) already installed on the wood inbuilt.

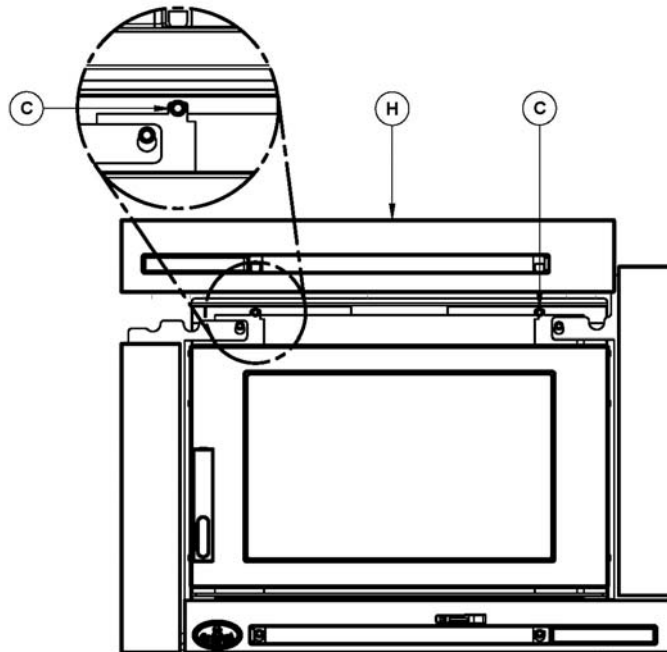

Manufactured by:

STOVE BUILDER INTERNATIONAL INC.

250, de Copenhague, Saint-Augustin-de-Desmaures (Quebec), Canada G3A 2H3

Tel: (418) 878-3040

Fax: (418) 878-3001

www.osburn-australia.com

Distributed by

Glen Dimplex Australasia

NEW ZEALAND

38 Harris Road, East Tamaki, Auckland

For servicing your heater

Call 0 800 666 2824

AUSTRALIA

Unit 1, 21 Lionel Road

Mount Waverley, Victoria 3149

For servicing your heater

Call 1 300 554 155